

*You are  
Invited*

**SATURDAY, NOVEMBER 7**  
**TWO SHOW TIMES: 4:30-6 PM & 6:30-8 PM**  
*Or pickup your meal and view from home!*

*Lights, Camera, Action! A Night of Vision for Expanding Hope, Impacting Lives.*

We are rolling out the red carpet for a special gala event!

Come dressed like the famous, be served a plated meal & experience the story  
of New Hope Church, Past, Present & Future

Childcare will be provided, so put the date  
on your calendar now!

RSVP details will becoming soon!



**NH** CAMPAIGN  
NEWSLETTER



ISSUE

**#2**



## ANSWERS TO YOUR QUESTIONS

• Campaign Committee Chair - Dan Mahlum

On September 7, a “Behind the Curtain” event was held at the church. Attendees asked several great questions of the building team. Here are the answers:

**Q: Has the parking lot paving and lighting plan been figured into this building plan?**

A: The Building Team is considering the paving and lighting of our parking lot in conjunction with their current work.

**Q: Will changes be made to the existing church space in addition to adding space?**

A: The Building Team is considering changes to the existing space as well as additional space as it determines the best functional and most efficient building layout to meet our ministry needs.

**Q: How much longer will the space at the intersection be available for use?**

A: The current lease for the church office and Intersection space expires at the end of August, 2021. The owner is willing to continue to rent to New Hope if the space is still needed by the church.

**Q: What is the estimated completion date for the expansion?**

A target completion date has not yet been established. We anticipate an end-to-end construction period of approximately 12 months. The timing for groundbreaking will be dependent upon: final design, construction bids, contractor selection, and a number of other factors.

VIEW THE LATEST  
CAMPAIGN  
INFORMATION AT

[NEWHOPEADEL.ORG/EXPANDING-HOPE](http://NEWHOPEADEL.ORG/EXPANDING-HOPE)

**Q: How are space need projections calculated in such a fast growing area?**

A: Church leaders used a projected community annual growth rate of 5% in order to project future space needs. For this building phase, a 5 year time frame was used (i.e. Vision 2025). The estimated average weekly church attendance in 2025 is projected to be 600 people. It is reasonable to assume that growth in this area of Dallas County will continue well beyond 2025. Church leadership will continue to assess future facility needs, whether under a single/current campus plan or through local church plants.

**Q: Is a larger kitchen and event space being examined as part of the expansion plan?**

A: Yes, absolutely! The Building Team anticipates the new multi-purpose space will be used for banquets and other community events and therefore, having adequate kitchen facilities near that space is a priority.

**Q: Is additional programing being considered when talking about physical building plans?**

A: We fully anticipate new ministries and programs will be necessary to meet the needs of a growing congregation. The multi-purpose space and flex-use design of the new space is intended to meet the needs of the growing and emerging ministries of New Hope!

## ANSWERS ABOUT FUNDRAISING

• Campaign Committee Chair - Dan Mahlum

**Q: How is New Hope handling fundraising for the building project?**

A: When fund raising is done in a biblical fashion it is not only a significant ministry but can be life changing! It is amazing to see God provide through the generous and sacrificial giving of His people. When God’s work is done in God’s way and under His direction, His provision is abundant!

Our approach to fundraising for the building project is modeled after King David’s steps to prepare for the building of God’s temple. First, he shared the vision and plan for the temple. Second, he prayed and asked the people to pray. Third, he invited the leaders to commit their resources to the building effort. And, finally, he invited all of the people to give resources to the building effort.

**Q: Where are we with respect to the capital campaign process?**

A: On September 13, Pastor Ryan announced the launch of our building campaign and shared the exciting vision for New Hope! On September 20, we then launched a church-wide prayer journey focused on God’s vision for the church as well as what God is asking of each of us as stewards of his resources. During the month of October leaders will be invited to prayerfully pledge resources toward the building effort. Then, on November 7 the whole church will be invited to a gala event during which everyone will be invited to prayerfully commit to the building expansion.

**Q: What period of time will the capital campaign cover?**

A: The pledged commitments will cover a period of just over 3 years. We will have an opportunity to give a “first fruits” contribution at the end of 2020 followed by commitments for the calendar years of 2021-2023.

**Q: What is our fundraising goal for the building project?**

A: We are working with Christian Investors (CI) as a consultant for our capital campaign. CI has led over 400 successful church fundraising campaigns and based on their experience, we have established the following target goal and miracle goal:

TARGET GOAL:

**\$1,300,000**

MIRACLE GOAL:

**\$1,800,000**

These numbers represent approximately 2.5 and 3.5 times our current annual church operating budget and that is how CI estimates capital campaign potential. However, we know from Psalm 24:1 that “The earth is the Lord’s, and everything in it”. As we prayerfully seek to understand God’s vision and his calling for each of us as stewards, he may choose to do immeasurably more than all we ask or imagine according to his power that is at work within us.

ARCHITECTURAL RENDERING

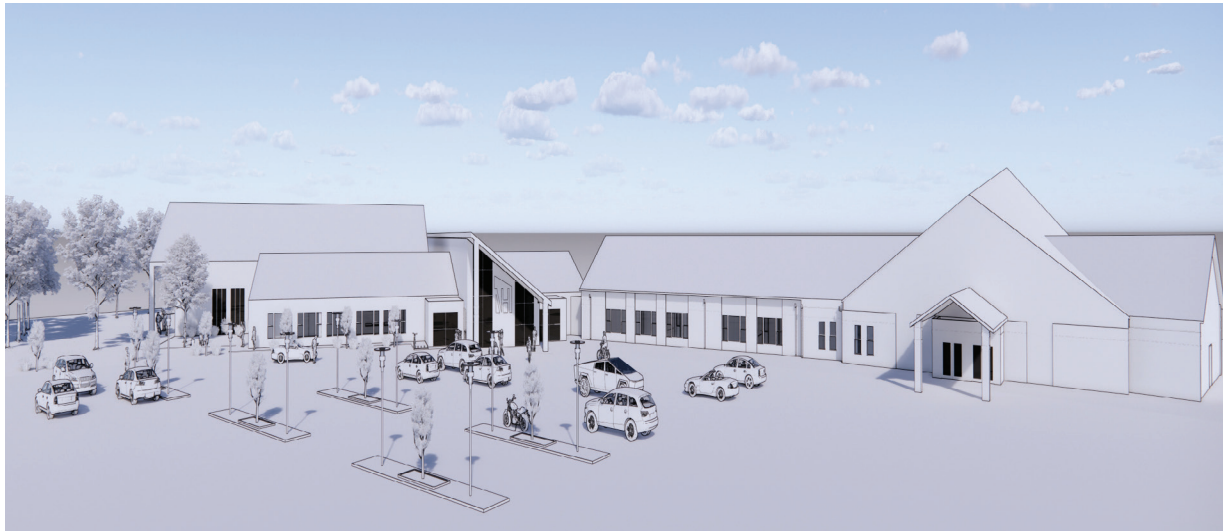

ARCHITECTURAL RENDERING





## CLOSE UP VIEW OF NEW ADDITION



## BUILDING COMMITTEE UPDATE

• Building Committee Chair - Steve Kinney

The Building Committee has been working diligently over the past few weeks. With the help of the architect, we are close to being able to present a final plan for the new addition.

Pictured you can see how the new addition will appear next to the current structure. The committee recently changed the plan, so the office addition is now on the south end of the existing building instead of the north end. This will allow for less disturbance during construction, and provide easier interaction with others in the building during the week.

We believe that this design addresses all of the discussed current and future needs and will be very useful to the church as well as the community. More details will continue to come!

Thank you for your continued prayers as we continue this process.

**FLOOR PLAN  
DETAILS  
COMING SOON!**

Virtual tours will be given at the  
First Fruits Gala on November 7!